

HARCO PVC C-900 GASKETED FITTINGS

DESIGN DATA

BELL SPECIFICATIONS

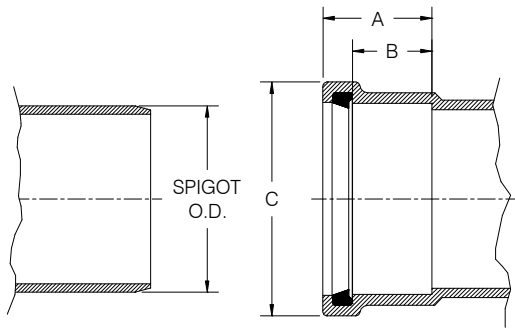

SIZE	STYLE	A	B	C	Spigot O.D.
4	Molded	4.3	3.1	6.3	4.80
6	Molded	4.8	3.5	8.6	6.90
8	Molded	5.4	4.0	11.0	9.05
10	Fab	9.0	5.0	13.0	11.10
12	Fab	9.5	5.5	15.5	13.20

LINE COUPLING

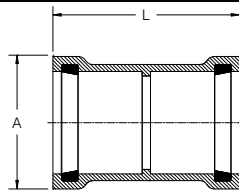

*Made by Certainteed from machined extrusion. (Molded fitting shown)

SIZE	PART No.	STYLE	A	L	WT. (approx.)
4	308-040	Molded	6.3	8.9	2.9
6	308-060	Molded	8.3	10.0	6.0
8	308-080	Molded	11.0	11.0	11.5
10	308-100	Molded*	13.0	19.7	27
12	308-120	Molded*	15.5	22.3	40

NOTES:

- All lay lengths & weights are approximate and are subject to change without notice.
- Fabricated fitting configurations may vary.

STYLE LEGEND:

Molded - Molded fittings are Pressure Class 150 unless otherwise noted.

Fab ----- Fabricated fittings are made from sections of C-900 pipe and are not pressure rated.

Warning: Frequent or severe cyclical pressure surges (water hammer) can destroy PVC fittings. Please refer to AWWA C-907, Section A.3.4 for additional details.

The use of anything but properly designed and installed thrust blocks will reduce the life of plastic fittings. Thrust blocks must be of poured concrete only and sized for the soil conditions. Joint restraint products are available.

REPAIR COUPLING

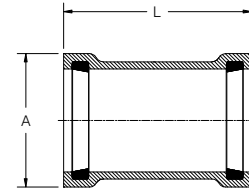

*Made by Certainteed from machined extrusion. Molded fitting shown)

SIZE	PART No.	STYLE	A	L	WT. (approx.)
4	309-040	Molded	6.3	8.9	3.4
6	309-060	Molded	8.6	10.0	6.7
8	309-080	Molded	11.0	11.3	12.5
10	309-100	Molded*	13.0	19.7	22
12	309-120	Molded*	15.5	22.3	36

TAPPED TEE (NPT Thread)

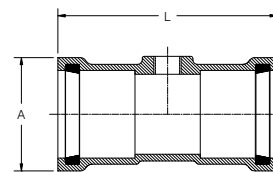

(Molded fitting shown)

SIZE	PART No.	STYLE	A	L	WT. (approx.)
4x $\frac{3}{4}$	351-403	Molded	6.9	12.0	5.0
4x1	351-404	Molded	6.9	12.0	5.0
4x1 $\frac{1}{2}$	351-406	Molded	6.9	12.0	5.0
4x2	351-408	Molded	6.9	12.0	5.0
6x $\frac{3}{4}$	351-603	Molded	8.5	13.0	9.2
6x1	351-604	Molded	8.5	13.0	9.2
6x1 $\frac{1}{2}$	351-606	Molded	8.5	13.0	9.2
6x2	351-608	Molded	8.5	13.0	9.2
8x $\frac{3}{4}$	351-803	Molded	11.0	14.9	16.0
8x1	351-804	Molded	11.0	14.9	16.0
8x1 $\frac{1}{2}$	351-806	Molded	11.0	14.9	16.0
8x2	351-808	Molded	11.0	14.9	16.0

TAPPED TEE (AWWA Thread)

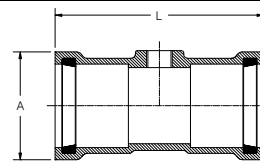

(Molded fitting shown)

SIZE	PART No.	STYLE	A	L	WT. (approx.)
4x $\frac{3}{4}$	352-403	Molded	6.9	12.0	4.3
4x1	352-404	Molded	6.9	12.0	4.3
4x2	352-408	Molded	6.9	12.0	4.3
6x $\frac{3}{4}$	352-603	Molded	8.5	13.3	8.5
6x1	352-604	Molded	8.5	13.3	8.5
6x2	352-608	Molded	8.5	13.3	8.5
8x $\frac{3}{4}$	352-803	Molded	11.0	14.9	15.0
8x1	352-804	Molded	11.0	14.9	15.0
8x2	352-808	Molded	11.0	14.9	15.0

CALL FOR OTHER SIZES, CONFIGURATIONS & GASKET MATERIALS.



THE HARRINGTON CORPORATION

P.O. BOX 10335 • LYNCHBURG VIRGINIA 24506 • PLANT 3721 COHEN PLACE • LYNCHBURG VIRGINIA 24501
 PHONE: (434) 845-7094 • FAX: (434) 845-8562 • E-mail: sales@harcofittings.com

HARCO PVC C-900 GASKETED FITTINGS

DESIGN DATA

CAP

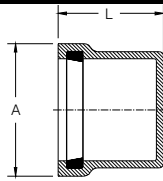

(Molded fitting shown)

For this item do not use joint restraint, poured concrete thrust blocks only.

SIZE	PART No.	STYLE	A	L	WT. (approx.)
4	349-040	Molded	6.3	4.5	2.1
6	349-060	Molded	8.6	5.2	4.5
8	349-080	Molded	11.0	6.0	8.5
6	350-060	Molded	8.0	5.0	4.5
10	349-100	Fab	13.0	13.7	7.0
12	349-120	Fab	15.5	17.8	10.0

REDUCER (BxS)

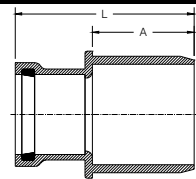

(Molded fitting shown)

SIZE	PART No.	STYLE	A	L	WT. (approx.)
6x4	316-0604	Molded	4.7	9.4	4.0
8x6	316-0806	Molded	5.3	10.5	7.7
8x4	316-0804	Fab	8.0	16.2	14.0
10x4	316-1004	Fab	9.6	18.3	22.0
10x6	316-1006	Fab	11.0	20.5	28.0
10x8	316-1008	Fab	10.5	20.7	27.0
12x4	316-1204	Fab	9.6	20.3	35.0
12x6	316-1206	Fab	11.4	21.9	38.0
12x8	316-1208	Fab	10.5	23.7	45.0
12x10	316-1210	Fab	10.5	24.0	43.0

C-900 BELL x FLANGE ADAPTER

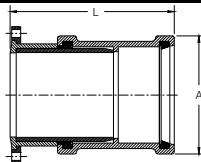

(Molded fitting shown)

These fittings use SCH-40 PVC fittings. SCH-40 PVC FITTINGS DO NOT HAVE LONG TERM PRESSURE RATING. See section 6.3.2 of ASTM D2466. Use of these in pressure systems is at users' risk.

SIZE	PART No.	A	L	WT. (approx.)
4	354-040	6.3	11.5	7.3
6	354-060	8.6	13.3	14.2
8	354-080	11.0	15.8	25.7

NOTES:

- All lay lengths & weights are approximate and are subject to change without notice.
- Fabricated fitting configurations may vary.

STYLE LEGEND:

Molded - Molded fittings are Pressure Class 150 unless otherwise noted.

Fab ----- Fabricated fittings are made from sections of C-900 pipe and are not pressure rated.

REDUCER (BxB)

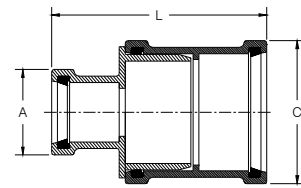

(Molded fitting shown)

SIZE	PART No.	STYLE	A	C	L	WT.(approx.)
6x4	317-0604	Molded	6.3	8.6	13.6	10.4
8x6	317-0806	Molded	8.6	11.0	15.3	19.6
8x4	317-0804	Fab	6.3	11.0	18.5	14.0
10x4	317-1004	Fab	6.3	13.0	23.1	22.0
10x6	317-1006	Fab	8.6	13.0	25.4	28.0
10x8	317-1008	Fab	11.0	13.0	25.5	27.0
12x4	317-1204	Fab	6.3	15.5	25.5	35.0
12x6	317-1206	Fab	8.6	15.5	27.0	38.0
12x8	317-1208	Fab	11.0	15.5	28.9	45.0
12x10	317-1210	Fab	13.0	15.5	29.0	43.0

MANHOLE ADAPTER

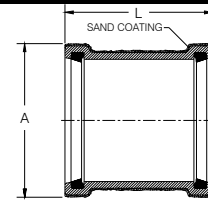

(Molded fitting shown)

SIZE	PART No.	STYLE	A	L	WT.(approx.)
4	357-040	Molded	8.9	6.5	3.4
6	357-060	Molded	10.0	8.8	8.0
8	357-060	Molded	11.3	11.2	15.0
10	357-100	Fab	13.3	19.7	24.0
12	357-120	Fab	15.8	22.3	28.0

CLEAN OUT ADAPTER (HUB)

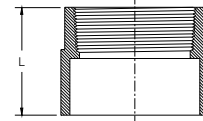

(Molded fitting shown)

Non-Pressure

SIZE	PART No.	STYLE	L	WT.(approx.)
4	359-040	Molded (Solvent Weld)	3.3	0.6
6	359-060	Molded (Solvent Weld)	4.4	1.3

90° BEND (BxB)

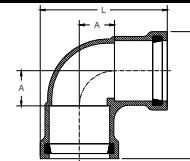

(Molded fitting shown)

SIZE	PART No.	STYLE	A	L	WT.(approx.)
4	318-040	Molded	2.8	10.3	6.0
6	318-060	Molded	3.9	13.1	12.0
8	318-080	Molded	5.1	16.0	23.0
10	318-100	Fab	12.0	28.5	52.0
12	318-120	Fab	14.0	34.5	80.0

CALL FOR OTHER SIZES, CONFIGURATIONS & GASKET MATERIALS.



THE HARRINGTON CORPORATION

P.O. BOX 10335 • LYNCHBURG VIRGINIA 24506 • PLANT 3721 COHEN PLACE • LYNCHBURG VIRGINIA 24501
PHONE: (434) 845-7094 • FAX: (434) 845-8562 • E-mail: sales@harcofittings.com

HARCO PVC C-900 GASKETED FITTINGS

DESIGN DATA

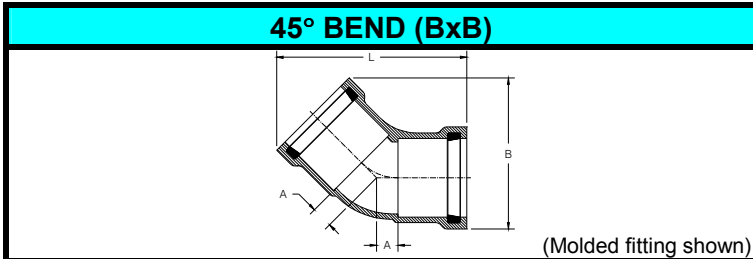

SIZE	PART No.	STYLE	A	B	L	WT. (approx.)
4	322-040	Molded	1.3	9.9	11.5	4.1
6	322-060	Molded	1.8	12.6	14.0	8.2
8	322-080	Molded	2.2	14.8	16.8	16.1
10	322-100	Fab	8.8	22.5	26.0	42.0
12	322-120	Fab	8.9	23.0	29.0	68.0

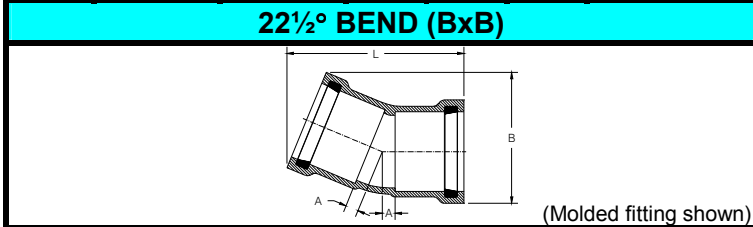

SIZE	PART No.	STYLE	A	B	L	WT. (approx.)
4	324-040	Molded	0.8	8.0	11.0	4.0
6	324-060	Molded	1.1	10.3	13.0	8.0
8	324-080	Molded	1.3	13.3	15.0	15.0
10	324-100	Fab	6.6	16.0	26.8	36.0
12	324-120	Fab	7.8	19.3	28.5	60.0

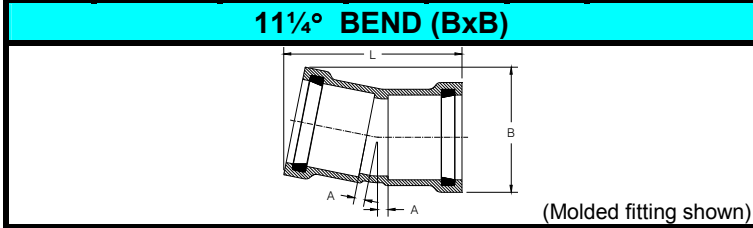

SIZE	PART No.	STYLE	A	B	L	WT. (approx.)
4	326-040	Molded	0.6	7.3	10.5	3.8
6	326-060	Molded	0.8	9.3	12.0	7.5
8	326-080	Molded	0.9	11.8	13.5	13.1
10	326-100	Fab	1.0	14.0	26.0	34.0
12	326-120	Fab	1.0	15.5	28.5	55.0

CALL FOR OTHER SIZES, CONFIGURATIONS & GASKET MATERIALS.

NOTES:

- All lay lengths & weights are approximate and are subject to change without notice.
- Fabricated fitting configurations may vary.

STYLE LEGEND:

Molded - Molded fittings are Pressure Class 150 unless otherwise noted.

Fab ----- Fabricated fittings are made from sections of C-900 pipe and are not pressure rated.

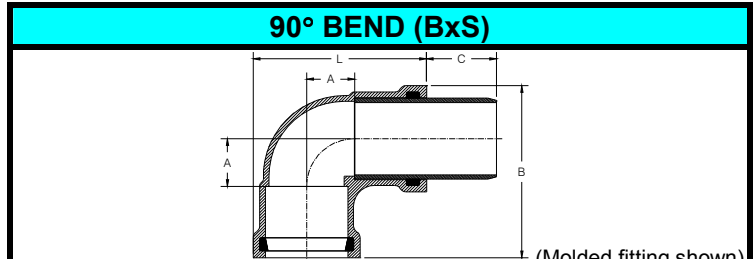

SIZE	PART No.	STYLE	A	B	C	L	WT. (approx.)
4	369-040	Molded	2.8	10.3	4.3	10.3	6.0
6	369-060	Molded	3.9	13.1	4.5	13.1	12.0
8	369-080	Molded	5.1	16.0	4.8	16.0	23.0
10	369-100	Fab	12.0	28.5	10.5	28.5	45.0
12	369-120	Fab	14.0	34.5	10.5	34.5	70.0

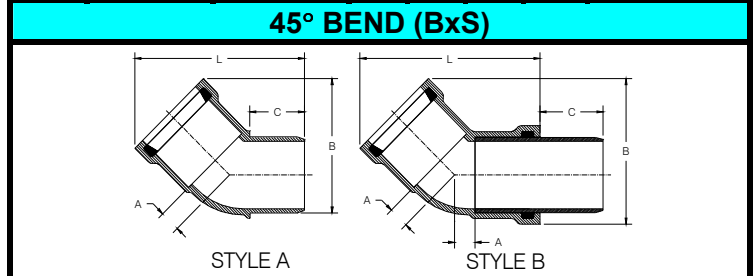

4" & 6" Non-Pressure

SIZE	PART No.	STYLE	A	B	C	L	WT. (approx.)
4	373-040	(A) Molded*	1.3	9.9	3.6	11.5	3.5
6	373-060	(A) Molded*	1.8	12.6	3.8	14.0	7.7
8	373-080	(B) Molded	2.2	14.8	4.8	16.8	16.1
10	373-100	Fab	8.8	22.5	10.5	26.0	35.0
12	373-120	Fab	8.9	23.0	10.5	29.0	58.0

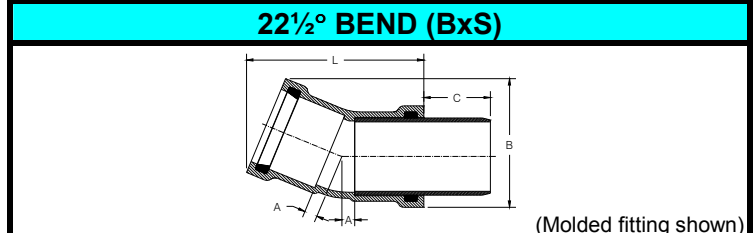

SIZE	PART No.	STYLE	A	B	C	L	WT. (approx.)
4	375-040	Molded	0.8	8.0	4.3	11.0	4.0
6	375-060	Molded	1.1	10.3	4.5	13.0	8.0
8	375-080	Molded	1.3	13.3	4.8	15.0	15.0
10	375-100	Fab	6.6	15.5	10.5	26.8	35.0
12	375-120	Fab	7.8	19.5	10.5	28.5	58.0

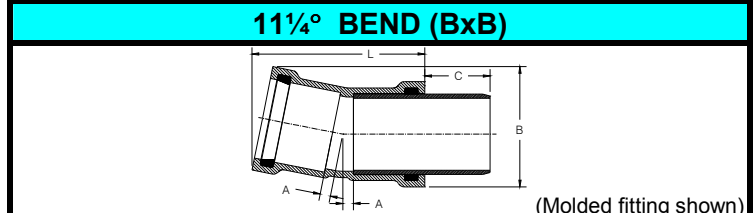

SIZE	PART No.	STYLE	A	B	C	L	WT. (approx.)
4	377-040	Molded	0.6	7.3	4.3	10.5	3.8
6	377-060	Molded	0.8	9.3	4.5	12.0	7.5
8	377-080	Molded	0.9	11.8	4.75	13.5	13.1
10	377-100	Fab	1.0	14.0	10.5	14.5	33.0
12	377-120	Fab	1.0	15.5	10.5	16.3	53.0



THE HARRINGTON CORPORATION

P.O. BOX 10335 • LYNCHBURG VIRGINIA 24506 • PLANT 3721 COHEN PLACE • LYNCHBURG VIRGINIA 24501
 PHONE: (434) 845-7094 • FAX: (434) 845-8562 • E-mail: sales@harcofittings.com

HARCO PVC C-900 GASKETED FITTINGS

DESIGN DATA

45° WYE BxBxSDR-35 B OUTLET

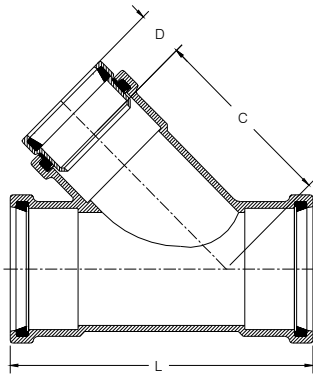

Non-pressure (Molded fitting shown)

SIZE	PART No.	STYLE	C	D	L	WT. (approx.)
4x4	303-0404	Molded	6.8	2.7	16.8	9.0
6x4	303-0604	Molded	9.6	2.7	21.3	16.0
6x6	303-0606	Molded	9.6	3.5	21.3	21.0
8x4	303-0804	Molded	10.2	2.7	21.8	29.1
8x6	303-0806	Molded	10.2	3.5	21.8	29.0
8x8	303-0808	Fab	14.0	4.0	34.4	60.0

45° WYE (BxB)

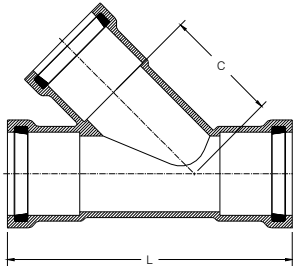

Non-pressure (Molded fitting shown)

SIZE	PART No.	STYLE	C	L	WT. (approx.)
4x4	301-0404	Molded	6.8	16.8	8.2
6x4	301-0604	Molded	9.6	21.3	15.0
6x6	301-0606	Molded	9.6	21.3	19.1
8x4	301-0804	Molded	10.2	21.8	28.1
8x6	301-0806	Molded	10.2	21.8	27.0
8x8	301-0808	Fab	10.0	34.4	39.0
10x4	301-1004	Fab	9.8	31.0	40.0
10x6	301-1006	Fab	9.7	33.5	48.0
10x8	301-1008	Fab	10.2	36.5	53.0
10x10	301-1010	Fab	11.4	39.5	53.0
12x4	301-1204	Fab	10.7	34.0	61.0
12x6	301-1206	Fab	11.2	36.8	70.0
12x8	301-1208	Fab	11.7	39.8	81.0
12x10	301-1210	Fab	12.9	42.5	97.0
12x12	301-1212	Fab	15.4	46.5	114.0

C-900 x SDR-35 (BxB) ADAPTER

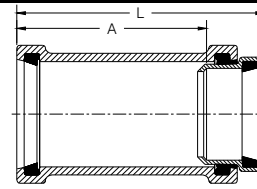

Non-pressure (Molded fitting shown)

SIZE	PART No.	STYLE	A	L	WT. (approx.)
4	337-040	Molded	7.4	10.0	2.0
6	337-060	Molded	7.6	11.1	2.0
8	337-080	Molded	8.7	12.5	7.5
10	337-100	Fab	12.0	19.5	12.0
12	337-120	Fab	13.5	21.0	18.0

SDR-35 x C-900 (BxS) ADAPTER

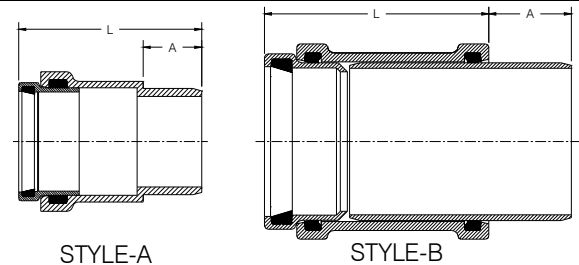

Non-pressure (Molded fitting shown)

SIZE	PART No.	STYLE	A	L	WT. (approx.)
4	334-040	(A) Molded	2.7	8.2	4.0
6	334-060	(A) Molded	3.7	10.0	6.0
8	334-080	(B) Molded	5.5	12.6	12.0
10	334-100	Fab	9.25	17.8	21.0
12	334-120	Fab	10.0	18.8	31.0

C-900 x SDR-35 (BxS) ADAPTER

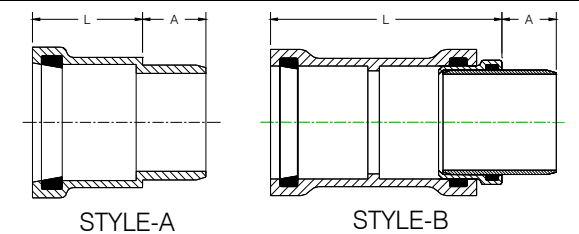

Non-pressure (Molded fitting shown)

SIZE	PART No.	STYLE	A	L	WT. (approx.)
4	335-040	(B) Molded	3.2	10.0	4.0
6	335-060	(A) Molded	2.9	3.5	2.0
8	335-080	(B) Molded	4.0	12.5	15.0
10	335-100	Fab	7.5	18.8	11.0
12	335-120	Fab	7.5	20.0	16.0

CALL FOR OTHER SIZES, CONFIGURATIONS & GASKET MATERIALS.

NOTES:

- All lay lengths & weights are approximate and are subject to change without notice.
- Fabricated fitting configurations may vary.

STYLE LEGEND:

Molded - Molded fittings are Pressure Class 150 unless otherwise noted.

Fab ----- Fabricated fittings are made from sections of C-900 pipe and are not pressure rated.



THE HARRINGTON CORPORATION

P.O. BOX 10335 • LYNCHBURG VIRGINIA 24506 • PLANT 3721 COHEN PLACE • LYNCHBURG VIRGINIA 24501
 PHONE: (434) 845-7094 • FAX: (434) 845-8562 • E-mail: sales@harcofittings.com

HARCO PVC C-900 GASKETED FITTINGS

DESIGN DATA

IPS x C-900 ADAPTER (BxS)

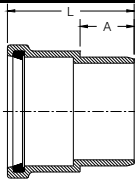

(Molded fitting shown)

SIZE	PART No.	STYLE	A	L	WT. (approx.)
4	339-040	Molded	2.7	7.0	2.4
6	339-060	Molded	3.7	8.6	5.0
8	339-080	Fab			28.0

TEE

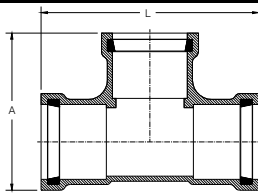

(Molded fitting shown)

SIZE	PART No.	STYLE	A	L	WT. (approx.)
4x4	312-0404	Molded	10.1	14.2	6.7
6x4	312-0604	Molded	12.3	15.4	11.5
6x6	312-0606	Molded	13.0	17.4	14.5
8x4	312-0804	Molded	14.9	16.3	19.0
8x6	312-0806	Molded	15.4	18.5	23.0
8x8	312-0808	Molded	16.0	20.9	26.0
10x4	312-1004	Fab	22.0	29.3	37
10x6	312-1006	Fab	23.0	30.3	40
10x8	312-1008	Fab	22.5	33.0	43
10x10	312-1010	Fab	22.5	35.5	68
12x4	312-1204	Fab	24.0	32.5	56
12x6	312-1206	Fab	25.0	33.5	60
12x8	312-1208	Fab	26.5	36.5	65
12x10	312-1210	Fab	26.0	38.5	72
12x12	312-1212	Fab	26.0	40.5	99

IPS x C-900 (BxB) ADAPTER

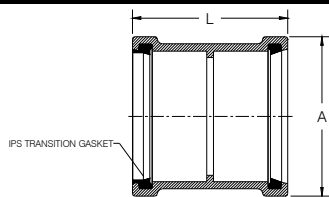

(Molded fitting shown)

Non-pressure

SIZE	PART No.	STYLE	A	L	WT. (approx.)
4	338-040	Molded	6.3	8.9	2.9
6	338-060	Molded	8.3	10.0	6.0
8	338-080	Molded	11.1	11.3	12.5

NOTES:

- All lay lengths & weights are approximate and are subject to change without notice.
- Fabricated fitting configurations may vary.

STYLE LEGEND:

Molded - Molded fittings are Pressure Class 150 unless otherwise noted.

Fab ----- Fabricated fittings are made from sections of C-900 pipe and are not pressure rated.

TAPPED PLUG (NPT Thread)

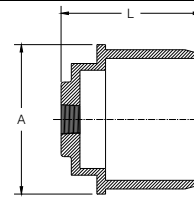

(Molded fitting shown)

Use poured concrete thrust blocks only.

SIZE	PART No.	STYLE	A	L	WT. (approx.)
4x ³ / ₄	345-403	Molded	5.3	4.5	1.2
4x1	345-404	Molded	5.3	4.5	1.2
4x1 ¹ / ₂	345-406	Molded	5.3	4.5	1.2
4x2	345-408	Molded	5.3	4.5	1.2
6x ³ / ₄	345-603	Molded	7.4	6.4	3.1
6x1	345-604	Molded	7.4	6.4	3.1
6x1 ¹ / ₂	345-606	Molded	7.4	6.4	3.1
6x2	345-608	Molded	7.4	6.4	3.1
8x ³ / ₄	345-803	Molded	9.5	7.3	6.2
8x1	345-804	Molded	9.5	7.3	6.2
8x1 ¹ / ₂	345-806	Molded	9.5	7.3	6.2
8x2	345-808	Molded	9.5	7.3	6.2

PLUG

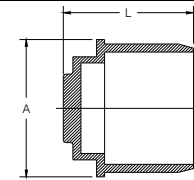

(Molded fitting shown)

Use poured concrete thrust blocks only.

SIZE	PART No.	STYLE	A	L	WT.(approx.)
4	344-040	Molded	5.3	4.5	1.2
6	344-060	Molded	7.4	6.4	3.1
8	344-080	Molded	9.5	7.3	6.2
10	344-100	Fab	12.3	14.0	21.0
12	344-120	Fab	14.5	14.0	32.0

TRANSITION GASKET C-900 x IPS

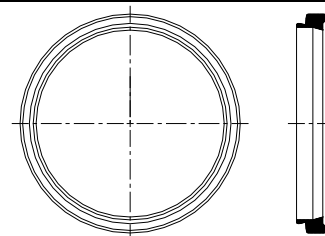

(Molded fitting shown)

Non-pressure

SIZE	PART No.	STYLE	WT. (approx.)
4	396-040	Molded	0.3
6	396-060	Molded	0.5
8	396-080	Molded	0.7

CALL FOR OTHER SIZES, CONFIGURATIONS & GASKET MATERIALS.



THE HARRINGTON CORPORATION

P.O. BOX 10335 • LYNCHBURG VIRGINIA 24506 • PLANT 3721 COHEN PLACE • LYNCHBURG VIRGINIA 24501
PHONE: (434) 845-7094 • FAX: (434) 845-8562 • E-mail: sales@harcofittings.com

THE HARRINGTON CORPORATION

P.O. BOX 10335 • LYNCHBURG, VIRGINIA 24506 • PHONE: (434) 845-7094
PLANT : 3721 COHEN PLACE TELEFAX (434) 845-8562

February 15, 2006

HARCO PVC FITTINGS to AWWA-C907

TO WHOM IT MAY CONCERN:

HARCO molded Pressure Class 150 (Pressure Rated 235 psi) PVC Pressure Fittings to AWWA-C907 (also referred to as C900 fittings) and gaskets meet the following specifications, standards and approvals:

- * AWWA C-907, Fittings
- ASTM D-1784, Materials
- ASTM D-3139, Joints
- ASTM F-477, Gaskets
- NSF Standard 61, Suitability for Potable Water

All Harco "molded" C900 fittings as shown in the Harco catalog and Design Data sheets are pressure rated and compliant with the standards cited above unless otherwise noted.

ROUTINE PRODUCTION TESTS

ASTM D-2122	-	Dimensional Check
ASTM D-1599	-	Short Time Burst Test
ASTM F610	-	Heat Reversion Test

THE HARRINGTON CORPORATION

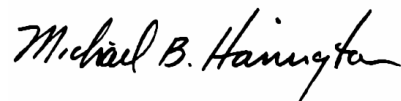

Michael B. Harrington
President